

# Bag Emptying Machine with Bale Press, Pallet Stacker and Pallet Infeed

## Description

- With the fully automatic bag emptying machine, granulate bags of 25 kg can be opened and emptied into a receiving bin.
- The capacity of the machine is between 10 and 15 tons of granules per hour.
- Emptying is better than 99.98%!
- It is also possible to transport or drop the empty bags (in)to a bag compactor or baler.
- The granulate in the receiving bin is transported from the bin by means of a granulate pump into the pneumatic transport system
- This system provides a durable and reliable transport to storage silos.

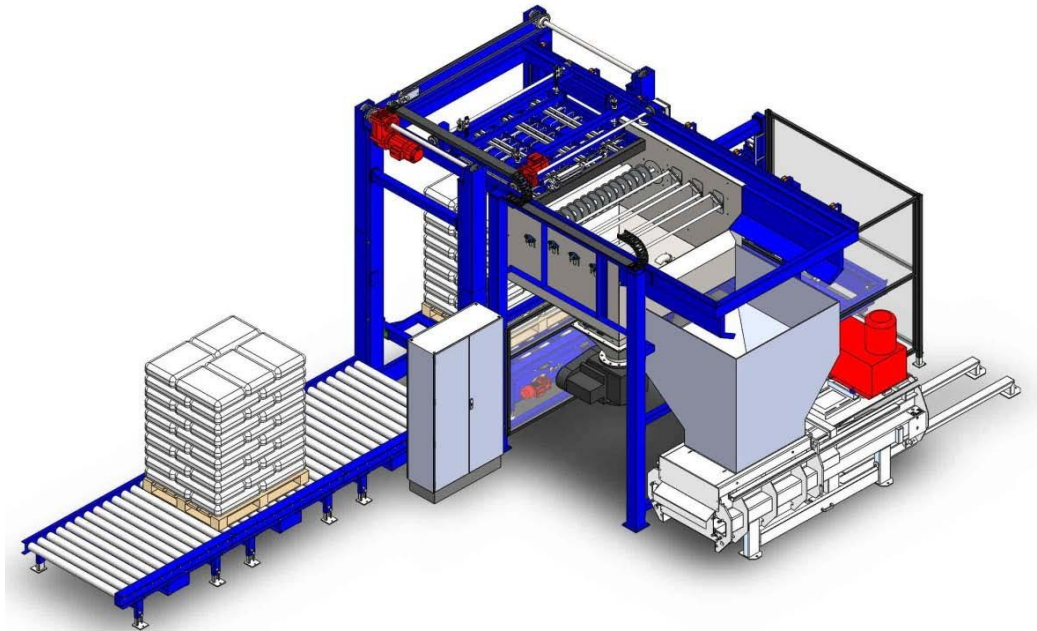

## Feature:

- Expandability: possibility to
  - Add a bag compactor
  - Add a pallet stacker
  - Implement in complex control system with full process control
- Flexibility (additional options, executions can be discussed)
- Robust execution
- Separated steady movements
  - Electrical lift executes vertical movement
  - Shuttle executes horizontal movements

## Layout:

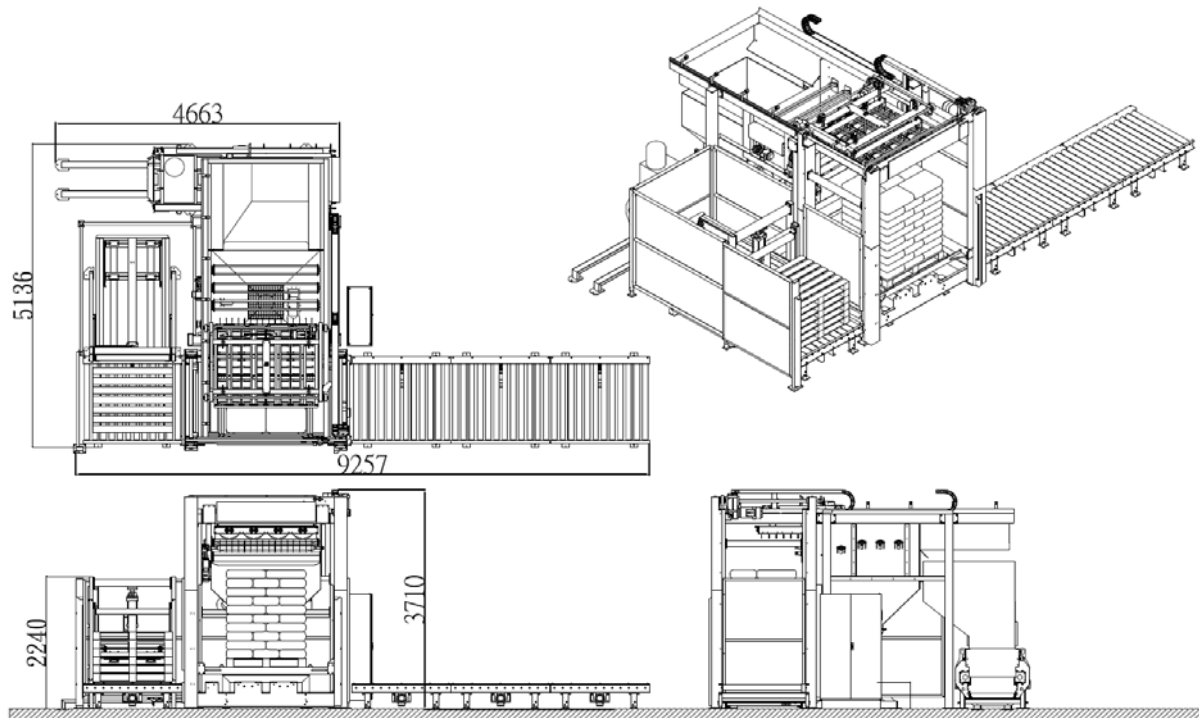

### Alternative designs and extra options:

- XL unit: Suitable for dumping granulate into containers, big bags, octabins or truckloads
- Automated cleaning: This machine can clean itself after a batch, so it is immediately ready for a different product
- Automatic pallet transport (in and out)
- Integrated palletstacker for stacking the empty pallets
- Integrated bag compactor or baler for the empty bags

### Specification of Pallet Stacker (Outfeed) :

- The lift unit will be equipped with electrically driven rollers for transporting the empty pallet to an outfeed conveyor (3 KW motor).
- The outfeed conveyor is also equipped with electrically driven rollers (0.37 KW motor). It is possible to take the pallets away from this conveyor by hand, forklift or choose for the automatic stacker option.
- Total Load: 3.37 KW

### Specification of Pallet Stacker (Pallet Infeed) :

- Overall length: 4,500 mm
- Width: 1,370 mm
- Roll length: 1,200 mm
- Roll distance: 135 mm
- Motor: SEW motor, 400V/50Hz, 0.37 KW\*3pcs (3 x frequency controlled)
- Travel speed: 12 m / min.
- Conservation : The frame in coated RAL color
- Conveyor rollers: Electrolytic galvanized
- Total Load: 1.11KW
- Height: 500 mm
- Roll Diameter: 89 mm Ø
- Roll Drive: chain 5/8", 15-tooth



科基企業有限公司

橡膠輔機設備專業製造、中央供料暨整廠自動化系統規劃執行  
Email: tigerkj@ms15.hinet.net [www.tigerkj.com.tw](http://www.tigerkj.com.tw)

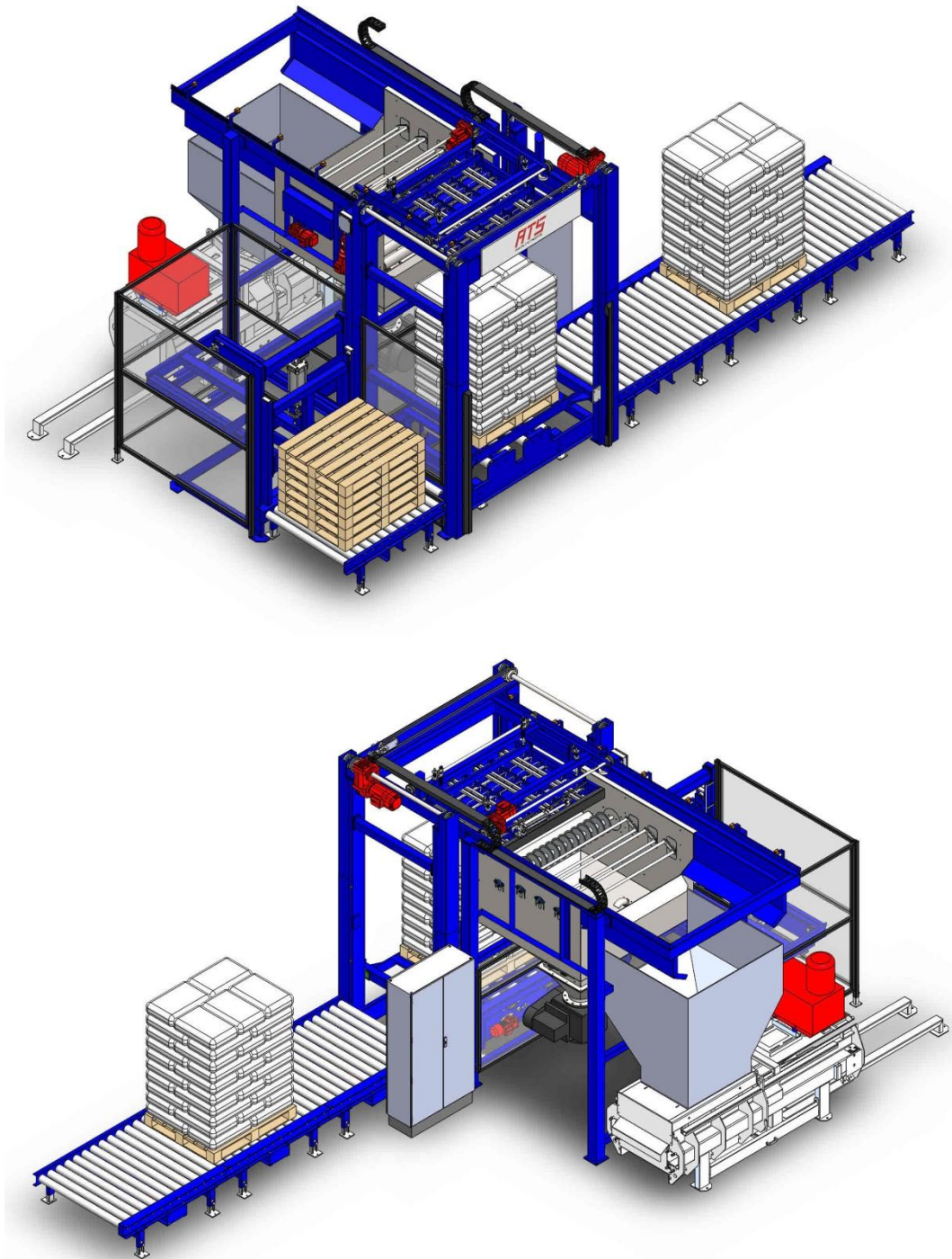

## Bag Emptying Machine with Bale Press, Pallet Stacker and Pallet Infeed